

# Villa Chaparral

BY  **Jacobson Homes**

# 1483

VC Lot 443  
10251 E. 35th Place  
\$177,500

**Livable Area:**

1,483 sq. ft.

**Footprint:**

3 Bedrooms

1 3/4 Bath

2 Car Garage

**Standards:**

Shingle roof

Low E Dual pane windows

Formica Kitchen tops

Cultured Marble bath tops

8' Ceilings

13" Floor tile everywhere except

For Living Room & Bedrooms

Ceiling Fans in Living Room & All Bedrooms

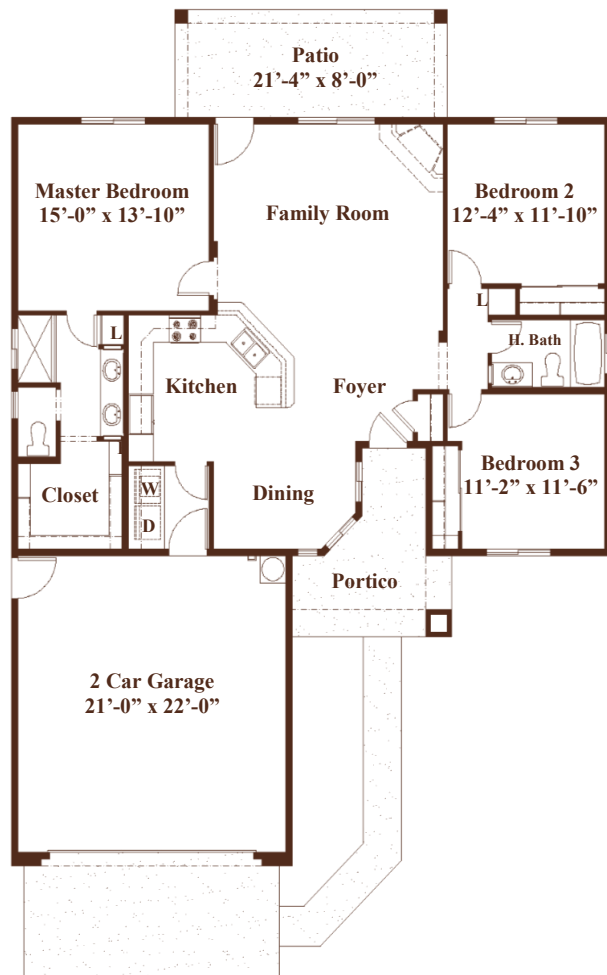

All dimensions and floor areas are approximate. Prices and specifications are subject to change without notice, solely at builder's discretion. Elevation drawings are artistic interpretations of the appearance of the design, which may differ from the actual results when built. Each home to be constructed is subject to terms of approval of a building permit by the City of Yuma. Options and additions depicted are not available on all plans or lots.



Main: 1334 S 5 Ave. | Sales: 3477 S Woodpecker Way Yuma, AZ 85364 | Tel: 928-329-9000 | Fax: 928-314-9980  
www. JacobsonHomesYuma.com

